

J. HISTORICAL AND ARCHAEOLOGICAL CONSIDERATIONS

As a result of a literature review, site file search and contact with local historians for the study area by Hartgen Archeological Associates, Inc., four (4) prehistoric archeological sites, one (1) historic archeological site, twenty five (25) historic structures and eight (8) cemeteries were identified (Exhibit II-J-1). National Register properties in the study area include the Simmons House, Szmyr Residence, Haswell House and Dunsbach House. The above referenced National Register properties are also located within the Town of Colonie National Register Multiple Resource Area which includes twenty-seven (27) properties scattered throughout the Town of Colonie and the Menands Park Historic District.

Included in Appendix 5 is a copy of the Technical Report specifically identifying historical and archeological resources of the study area. Detailed information such as maps, photographs and descriptions are included.

Impacts and Mitigation Measures

Both prehistoric and historic archeological sites are listed in the Office of Parks Recreation and Historic Preservation files. Prehistoric sites are also listed at the New York State Museum. As indicated in the report prepared by Hartgen Archeological Associates, Inc. the physiographic characteristics of the study area suggests a mixed probability of producing prehistoric archeological data. Areas near streams, swamps and rock faces have higher than average probability of producing prehistoric cultural materials. This is evidenced by the four (4) prehistoric sites identified by the study; three (3) are located within one (1) mile of the Delphus Kill and Mohawk River and the fourth site is near the



SCALE: 1" = 2000'

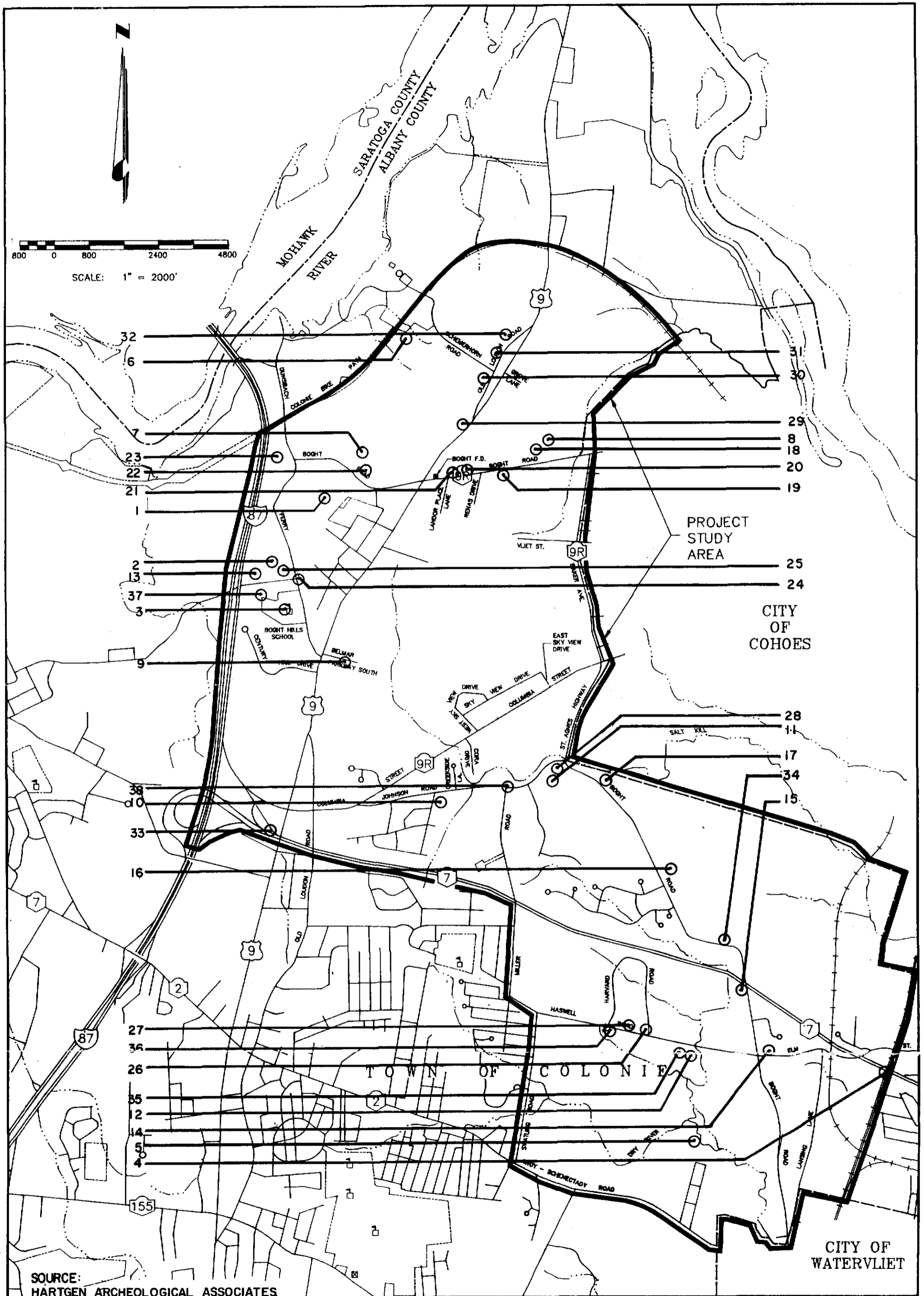

SOURCE:
HARTGEN ARCHEOLOGICAL ASSOCIATES

CHA **CLOUGH, HARBOUR & ASSOCIATES**
ENGINEERS & PLANNERS

REPORTED ARCHEOLOGICAL SITES, CEMETERIES & HISTORIC STRUCTURES

BOGHT ROAD - COLUMBIA STREET AREA, DRAFT GEIS, TOWN OF COLONIE

EXHIBIT II - J - 1

EXHIBIT II-J-1

LEGEND

REPORTED ARCHEOLOGICAL SITES, CEMETERIES AND HISTORIC STRUCTURES

<u>Map</u>	<u>OPRHP Site #</u>	<u>NYSM#</u>	<u>Site Name</u>	<u>Approximate Date</u>
1	A001-04-0051	966	Boght	Prehistoric
2	A001-04-0050	965	Mortar	Transition-Owasco (1000B.C-1500AD)
3	A001-04-0052	967	Gravel Pit Site	Prehistoric
4	A001-04-0030		First Whipple Bridge	1852-1853
5	A001-04-0069		Kanawha Site	Early archaic
6			VanDenBergh Cemetery	ca. 1850
7			Weaver Cemetery	ca. 1860+
8			Simmons Cemetery	ca. 1850
9			Roff Cemetery	
10			Mark Cemetery	ca. 1812
11			Lansing Farm Cemetery	
12			Haswell Cemetery	
13			Runkle Farm Cemetery	ca. 1830
14	001-04-0304		Judge Keller House	ca. 1859
15	001-04-0311		H. Rosencrans Residence	ca. 1890-1910
16	001-04-0305		Cherry Hill Farm	ca. 1840
17	001-04-0306		Van Vranken Farm	ca. 1790-1800
18	001-04-0307		Simmons House (MRA)	ca. 1720
19	001-04-0312		Szmyr Residence (MRA)	ca. 1847
20	001-04-0308		Reformed Church	1847
21	001-04-0309		Telefus Residence	1898
22	001-04-0310		Wilson Residence	ca. 1840
23	001-04-0316		Dunsbach House (MRA)	ca. 1840
24	001-04-0313		Atkinson Residence	1868
25	001-04-0315		Colonial (Colonie) Acres (Runkle Homestead)	ca. 1840-1860
26	001-04-0234		Haswell House (MRA)	1880
27	001-04-0235		Behuniak Residence	ca. 1920
28	001-04-0236		Gould Residence	ca. 1790
29	001-04-0298		Paragon Enterprise Business Office	ca. 1830-1850
30	001-04-0299		Coughlin Residence	ca. 1855-1865
31	001-04-0300		Schermerhorn Residence	1926
32	001-04-0301		Maxin Realty Corp	ca. 1850
33	001-04-0209		Witbeck House	ca. 1840-1850
34			Wiswall House	ca. 1860
35			Kruegler Farm	ca. 1830
36			French Residence	ca. 1890
37			Comley Residence	
38			E. Butler Residence	ca. 1860

*MRA = a component of the Town of Colonie Multiple Resource Area

Dry River. At the above referenced locations as well as in areas where the probability of finding prehistoric materials is high, a site specific 1A/1B Cultural Resources Survey should be required as part of the review process for specific development proposals.

If cultural resources are found as a result of the above mentioned surveys, mitigation measures are normally outlined as part of the Stage 1A/1B report. These measures may include but are not limited to avoiding construction activities in the affected area of the site or filling the affected area to limit the potential for future disturbance. Depending on the type and extent of cultural resources found, the Stage 1A/1B Cultural Resources Survey may recommend a Stage 2 Archeological Study which involves a dig and is much more intensive than the 1B.

A number of historic structures and cemeteries are located within the study area. These locations are shown in the Historical and Archeological Report contained in Appendix 5. Four (4) of these structures are on the Town of Colonic National Register Multiple Resource Area which is listed on the National Historic Register. Because the earliest historic map is dated approximately fifty (50) years after the Boght Road - Columbia Street area was settled, it is possible that some sites were abandoned during this fifty (50) year period and adjacent lands within two hundred (200) to three hundred (300) feet along earlier roads are considered sensitive to the presence of archeological deposits. Other sensitive locations include areas where structures have been identified but are no longer standing.

The historic sites as identified above and in Appendix 5 are all considered sensitive. Stage 1A/1B studies as described in the prehistoric sites portion of this section should be undertaken if development is proposed for one of these areas. Sites that are deemed particularly sensitive may be protected through zoning overlay districts, public acquisition or acquisition by private historic groups. Negotiations with the project sponsor may result in incorporation of the historic structure into the site plan or the moving of the structure to another location.